



## Pluslife Monkeypox Virus Card

Monkeypox Virus



**MONKEYPOX**



A rapid, accurate, on-site POC molecular test for monkeypox virus



## Pluslife Monkeypox Virus Card

Pluslife Mini Dock is a rapid molecular diagnostic system that can be used to detect Monkeypox virus (MPXV). Our self-developed isothermal amplification technology, RHAM, provides excellent results comparable to qPCR tests. The product is compact and portable, with easy-to-operate procedure to obtain results within 30 minutes.

## Features

---



FAST

TAT within 30 mins



EASY

Hand-on time within 2 mins



ACCURATE

LoD of 500 copies/mL



ACCESSIBLE

Sample to result within 4 steps

## Test Procedure

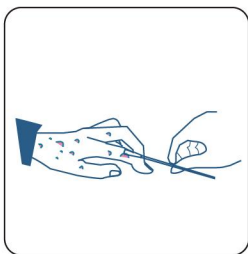

### 1. Collect Sample

Collect sample from lesion exudate with swab

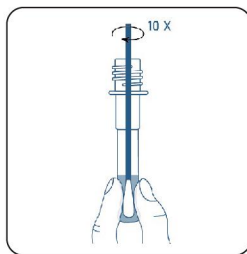

### 2. Mix Sample

Insert the swab into sample tube, mix and squeeze 10 times, and dispose

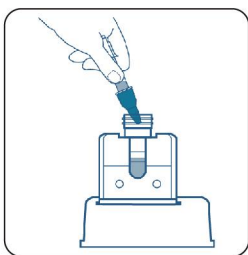

### 3. Prepare the Reaction Card

Transfer the sample to the chambers of the reaction card



### 4. Run Test

Turn on the device and insert the reaction card to start the test

## Result Output



✓ Mini Dock



✓ PC Software



✓ Mobile App

## Application



Hospitals



Clinics



Test Centers



Others

## Specification

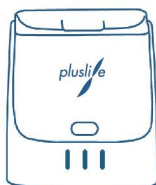

### Pluslife Mini Dock

Dimension	101 x 91 x 65 mm
Weight	210 g
Connection	Computer software or mobile app
Operate temperature	15°C–30°C
Operate humidity	≤ 80%

### Pluslife Monkeypox Virus Card

Target pathogen	MPXV
Limit of detection (LoD)	500 copies/mL
Turnaround time (TAT)	30 mins
Shelf life	9 months at room temperature
Sample type	Lesion exudate samples swab

## Guangzhou Pluslife Biotech Co.,Ltd.

Floor 3, Block E, Runhui Science & Technology Park, No.18 Shenzhou RD, Huangpu District, Guangzhou, Guangdong, China

+86-020-31703986 market@pluslife.com www.pluslife.com



Website



LinkedIn



Line